

Rovatti pumps can offer high standard of performance, reliability and much more added value

## WE ARE TALKING ABOUT MAINTENANCE

The development of EUROPA pump series has been oriented towards the improvement of maintenance procedures integrating two efficient and cheap systems unique on the pump market:

### “ TWINNER ” System

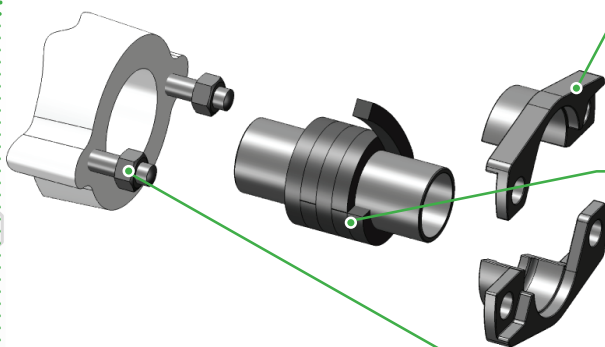

Flange in two stainless steel halves that through a simple extraction greatly facilitates the replacing operations of stuffing-box packing

Easy to adjust and long-term functioning stuffing-box packing on stainless steel chromium coated bush

Stainless steel screws that allow easy disassembling even after several operation hours

### Rapid Reset Kit

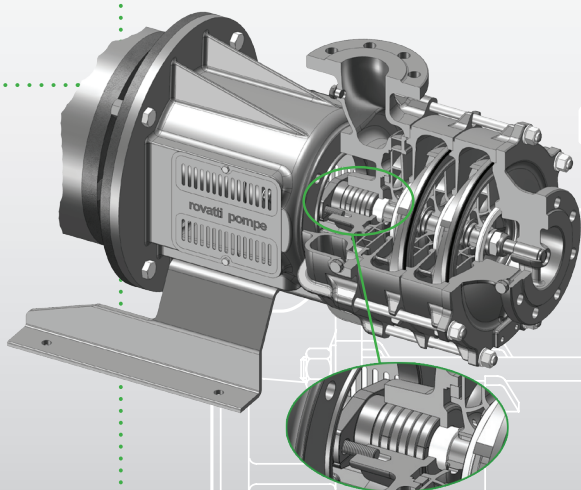

It is supplied in a handy storage carry case and includes all interchangeable wearing parts of the pump body. This allows a fast and easy restore “on site” of original pump performance

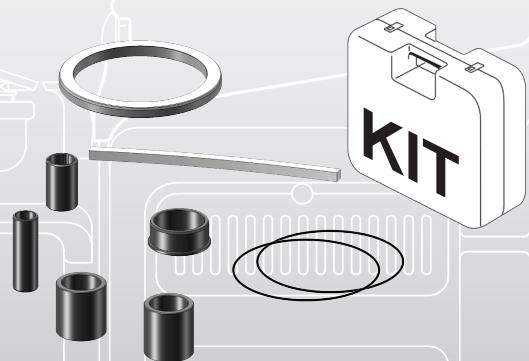

***Rapid, easy and cheap maintenance***

Le pompe Rovatti non si scelgono solamente per gli elevati standard di prestazioni e affidabilità, ma anche e soprattutto per il valore aggiunto che sono in grado di offrire

## PARLIAMO DI MANUTENZIONE!

Lo sviluppo della gamma EUROPA si è orientato verso il perfezionamento delle procedure di manutenzione integrando due sistemi efficaci ed economici unici sul mercato:

### “ TWINNER ” system

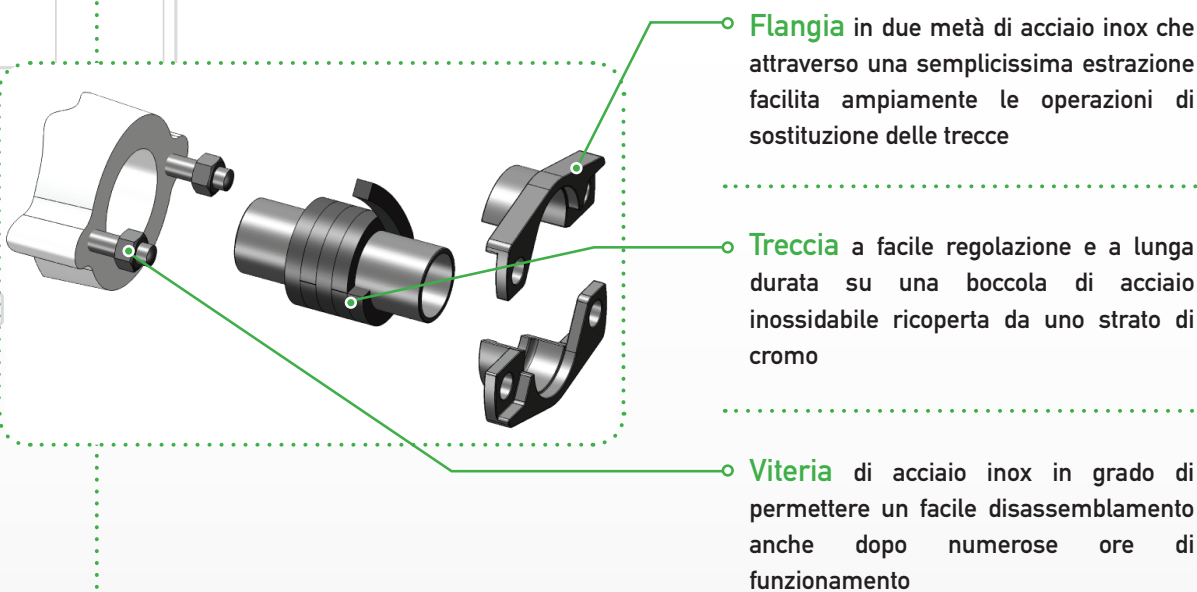

### Kit di pronto ripristino

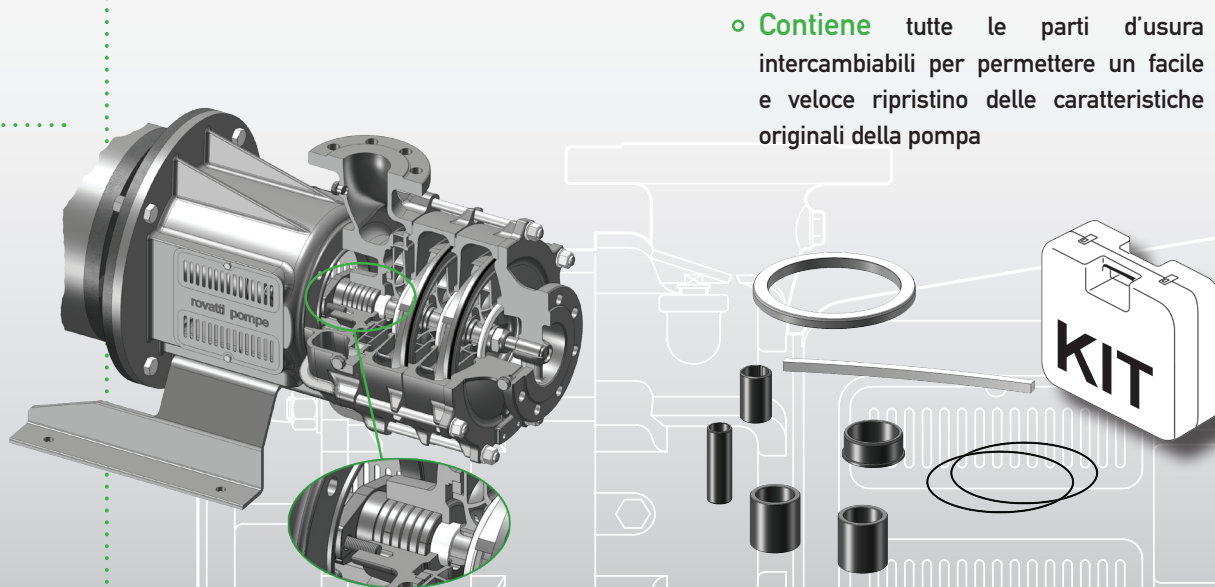

**Manutenzione semplificata, rapida ed economica**

**Rovatti A. & Figli Pompe Spa**

42042 Fabbrico (RE) - Italy

Tel.: +39 0522 665000 - Fax: +39 0522 665020

info@rovatti.it - www.rovatti.it